



WILLOW CREEK VILLAS

WEST DES MOINES

PLAT 1

www.jerryshomes.com

You'll find no shortage of activities and recreation near Jerry's Homes new Willow Creek development just off Veterans Parkway. Explore Raccoon River Park where water lovers can experience Blue Heron Lake and it's sandy beach, dog park, nature lodge and sports complex. Hike the trails in nearby Browns Woods, a popular wildlife refuge. Visit Historic Valley Junction known for farmers markets, shopping and entertainment. Holiday Park is home to baseball games and events and the Aquatic Center provides summer fun for all ages. Easy access to Hwy 5 bypass, close proximity to Des Moines airport and a quick commute to downtown. Ten minutes from West Glen and Jordan Creek area restaurants and shopping. Outstanding West Des Moines schools. For quality, affordable homes trust Jerry's Homes, central Iowa's leading home building since 1957.

School District
West Des Moines

Nearest Schools
Jordan Creek Elementary
Valley Southwoods

Nearest Grocery
Hy-Vee

Nearest Gym
Elite Edge, Aspen

Outdoor Ammenities
Brown's Woods,
Walnut Woods State Park
Willow Creek Golf Course
Great Western Bike Trail

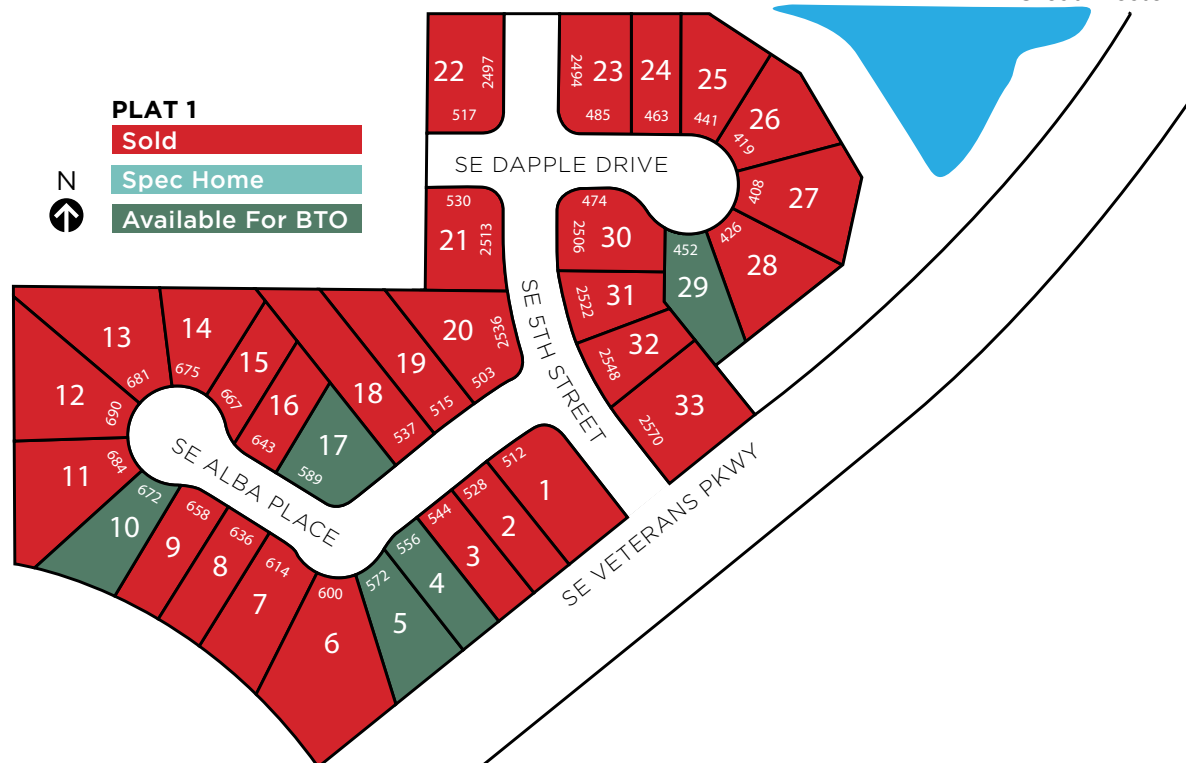

LOT	ADDRESS	TYPE	LOT SQFT	PRICE
4	556 SE ALBA PL	Standard	7,217	\$68,000
5	572 SE ALBA PL	Standard	9,246	\$70,000
10	672 SE ALBA PL	Standard	9,503	\$72,000
17	589 SE ALBA PL	Standard	9,407	\$67,000
29	452 SE DAPPLE DR	Daylight	8,151	\$69,000

John Gentile | 515.771.6407 | John@johngentilerealtor.com

Listing information subject to change without notice.

#SINCE1957



Our history builds your future.