

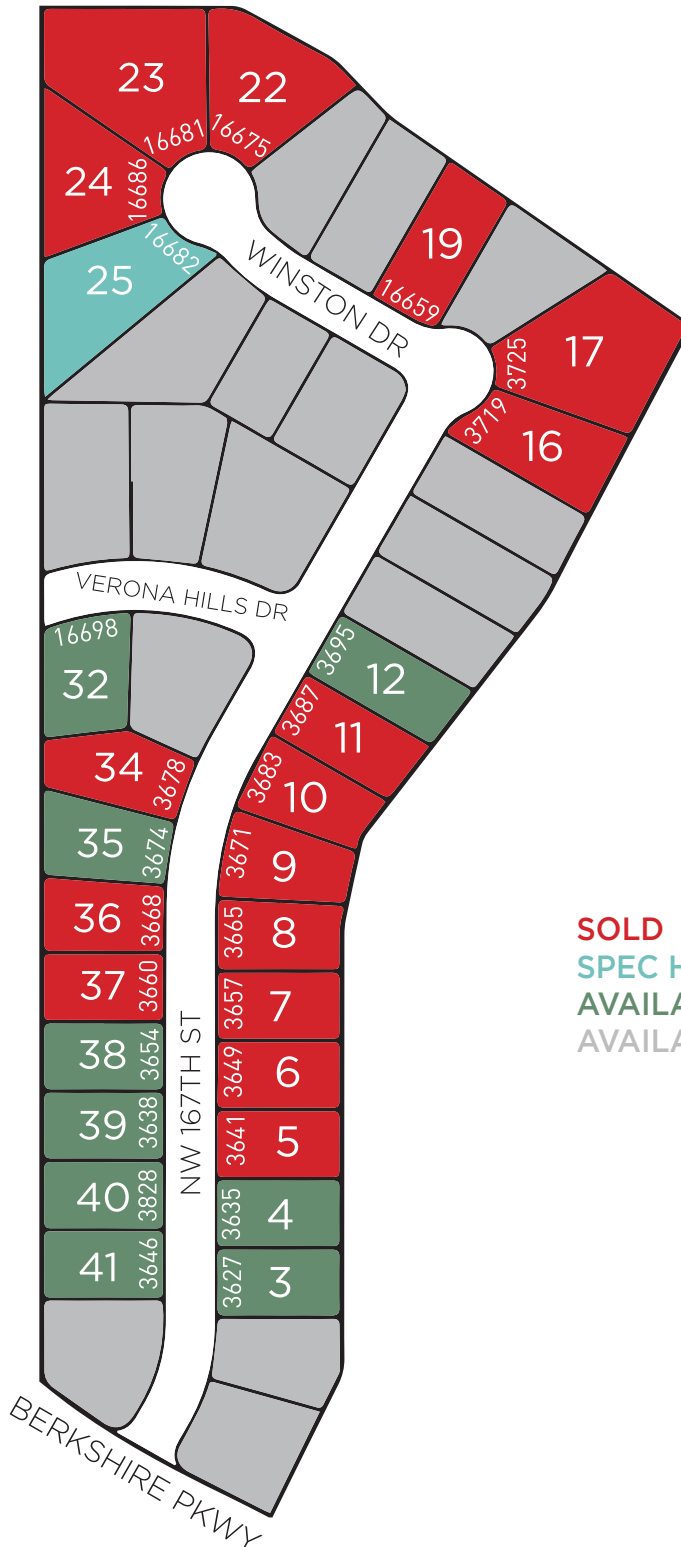

ANGEL PARK

CLIVE | PLAT SEVEN



SOLD
SPEC HOME
AVAILABLE LOT
AVAILABLE FOR BTO

JOHN GENTILE | 515.771.6407 | JGENTILE@REALESTATECONCEPTS.NET | JERRYSHOMES.COM

Listing information subject to change without notice. Daylight lots are an additional \$3,000 above listing price.
 Walkout lots are an additional \$6,000 above listing price.





ANGEL PARK

CLIVE | PLAT SEVEN

LOT	LOT PRICE	TYPE	LOT SQFT	PLAN	ADDRESS
3	\$93,000	WALKOUT	11,600	LOT	3627 NW 167TH ST
4	\$93,000	WALKOUT	11,600	LOT	3635 NW 167TH ST
7	\$89,500	WALKOUT	11,600	LOT	3657 NW 167TH ST
12	\$140,000	WALKOUT	13,898	LOT	3695 NW 167TH ST
25	\$925,000	WALKOUT	21,595	HOUSTON	16682 WINSTON DR
32	\$89,500	STANDARD	13,776	LOT	16698 VERONA HILLS DR
35	\$94,000	WALKOUT	12,221	LOT	3674 NW 167TH ST
38	\$89,500	WALKOUT	11,329	LOT	3654 NW 167TH ST
39	\$89,500	WALKOUT	11,325	LOT	3638 NW 167TH ST
40	\$89,500	DAYLIGHT	11,321	LOT	3828 NW 167TH ST
41	\$89,500	STANDARD	11,317	LOT	3646 NW 167TH ST

JOHN GENTILE | 515.771.6407 | JGENTILE@REALESTATECONCEPTS.NET | JERRYSHOMES.COM

*Listing information subject to change without notice. Daylight lots are an additional \$3,000 above listing price.
Walkout lots are an additional \$6,000 above listing price.*

