



With one of the most affordable and accessible pieces of ground developed in Waukee in the last 5 years, this development will have immediate access to Grand Prairie Parkway via Westtown Parkway. Homes in this area are in the heart of the burgeoning Kettlestone area. Soon to be minutes from shopping, dining and trails! You'll be able to find the perfect location to lay your roots down in one of Waukee's premiere developments, Kettlestone Ridge.

School District
Waukee

Nearest Schools
Maple Grove Elementary, South Middle School, Timberline School (grades 8-9), Waukee High School

Nearest Grocery
Fareway, Hy-Vee

Nearest Gym
YMCA of Waukee, Lifetime Fitness

Nearest Shopping Center
Jordan Creek Town Center

Nearest Hardware/Home Improvement Store
Lowe's and Menards

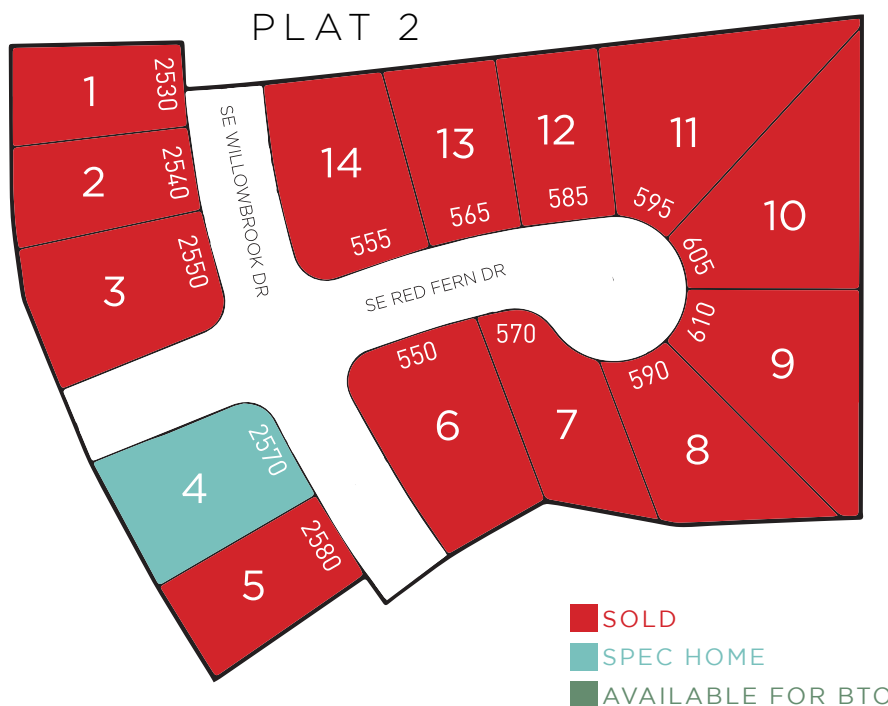

LOT #	ADDRESS	TYPE	LOT SQFT	PRICE	STYLE
4	2570 SE WILLOWBROOK DR	Walk-Out	13,483	\$359,500	BENTLEY HERITAGE



Listing information subject to change without notice. Daylight lots are an additional \$3,000 above listing price. Walkout lots are an additional \$6,000 above listing price.

